

SPRINKLERS

MINI SPRINKLERS

TECH TIP

HOW TO BUILD YOUR COOLNET

1. SELECT THE COOLNET HEAD

Choose the CoolNet Pro head for your application based on the operating pressure.

(CoolNet Heads on previous page).

2. SELECT THE DROPPER ASSEMBLY

This depends on the length you require and the type of lateral pipe (PVC/HDPE or LDPE).

PVC / HDPE

Choose a Dropper Assembly with M x F Press Fit Connector plus the Conic 3/8" x F Press Fit Connector 63000-002130.

To fit the Conic Connector in PVC/HDPE use a 5/16" (7.9mm) Drill & 3/8" BSW INTERMEDIATE Screw Tap

LDPE

Choose a Dropper Assembly.

With Barb x F Press Fit Connector.

3. SELECT THE REQUIRED ANTI-DRAIN VALVE

Choose the AD (Anti Drain) Valve based on your operating pressure.

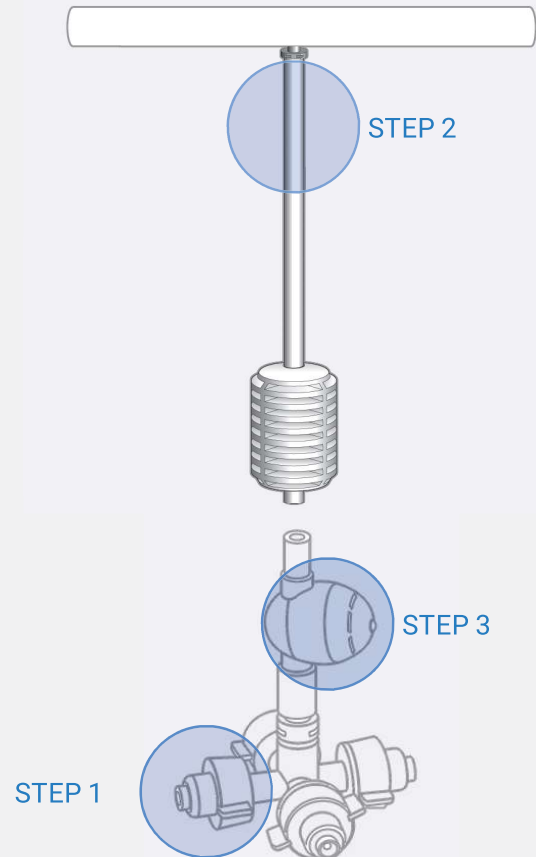

PROPAGATION BENCHES INFORMATION

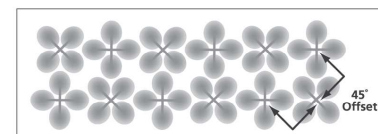
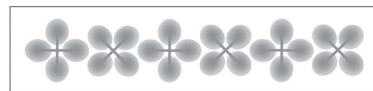
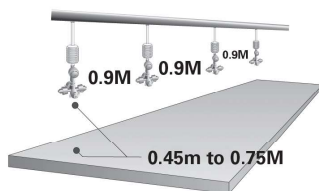

3 TO 4 FOOT BENCH

The height of the mister assembly should be 0.45m to 0.75m above the propagation material. The distance between the mister assemblies should be 0.9m. (Place the lateral above the center of a 0.9m to 1.2m bench).

WIDE BENCH

For wide benches (up to 2.4m) use two lines of misters equal distance from the center of the bench. For large areas, use one row of misters for every 1.2m width of area to be irrigated.

45° OFFSET

4-way crosses should be placed at 45° angles to one another.

F22

SPRINKLERS

MINI SPRINKLERS

PERFORMANCE DATA



| SPINNET SPRINKLER | | | | | | |
|-------------------|---------------|-------------|----------------|---|------|-----|
| FLOW RATE | NOZZLE COLOUR | NOZZLE SIZE | PRESSURE RANGE | WETTED DIAMETER (M) & SWIVEL COLOUR 150CM ABOVE GROUND AT 25M | | |
| | | | | L/HR | MM | M |
| 50 | Green | 0.90 | 20 - 30 | n/a | n/a | 6.0 |
| 70 | Black | 1.07 | 20 - 30 | 6.0 | 8.0 | 6.0 |
| 90 | Orange | 1.22 | 20 - 30 | 7.0 | 8.5 | 6.5 |
| 105 | Light Blue | 1.32 | 20 - 30 | 7.5 | 8.5 | 6.5 |
| 120 | Red | 1.44 | 20 - 30 | 7.5 | 9.5 | 6.5 |
| 160 | Brown | 1.76 | 20 - 30 | 8.5 | 10.0 | 7.5 |
| 200 | Yellow | 1.86 | 20 - 30 | 8.5 | 10.5 | 7.5 |

Nominal Flow at 23m pressure

TECH TIP

HOW TO BUILD YOUR SPINNET

1. SELECT THE SPINNET SPRINKLER HEAD

Select the SpinNet head that provides the desired uniformity and application rate by utilising the SpinNet brochure or speak with your local Netafim representative.

2. SELECT THE DROPPER ASSEMBLY

This depends on the length you require and the type of lateral pipe (PVC/HDPE or LDPE).

PVC / HDPE

Choose a Dropper Assembly with M x F Press Fit Connector plus the Conic 3/8" x F Press Fit Connector 63000-002130. To fit the Conic Connector into PVC/HDPE use a 5/16" (7.9mm) Drill & 3/8" BSW INTERMEDIATE Screw Tap

LDPE

Choose a Dropper Assembly. With Barb x F Press Fit Connector.

3. SELECT THE REQUIRED ANTI-DRAIN VALVE

Choose the AD (Anti Drain) Valve based on your operating pressure.

4. SELECT THE SHOULDER DISTRIBUTOR (SD) DEVICE

For irrigating tunnels we recommend the use of the SD (Shoulder Distributor) Device. This is fitted between the AD (Anti Drain) Valve and the sprinkler head.



F24