

Horizontal Multistage Pumps

50 Hz Stainless Steel MH 9 Specifications

Technical data 50Hz

Single-phase 220-240 V 50 Hz		Three-phase 380-415V 50Hz		Number of Stages	Motor Power		Input Power		Internal Capacitor		Rated Current		
Model No.	Order No.	Model No.	Order No.		kW	HP	kW	μF	V	Single-phase	Three-phase		
										220-240 V 50 Hz	220-240 V 50 Hz	380-415 V 50 Hz	
9AMH2B-51	96141009102	9AMH2B-53	96141009302	2	0.75	1	0.90	1.6	450	4.3	3.1	1.8	
9AMH3B-51	96141009103	9AMH3B-53	96141009303	3	1.1	1.5	1.37	30	450	6.4	4.7	2.7	
9AMH4B-51	96141009104	9AMH4B-53	96141009304	4	1.5	2	1.77	30	450	8.2	6.1	3.5	
-	-	9AMH5B-53	96141009305	5	1.85	2.5	2.21	-	-	-	6.9	4.0	
-	-	9AMH6B-53	96141009306	6	2.2	3	2.61	-	-	-	7.8	4.5	

Single-phase motors: 220-240 V ± 5 % / 50 Hz. Thermal protection built into the motor.

Three-phase motors: 380-415 V ± 5 % / 50 Hz. Thermal protection to be provided into the starter panel by the installer.

Dimensions and weights

Single-phase 220-240 V 50 Hz	Three-phase 380-415 V 50 Hz	Dimensions								Packaging				
Model No.	Model No.	A mm	E mm	G mm	D mm	F mm	G (mm)		DN1	DN2	L mm	B mm	H mm	Weight (kg)
							1-phase	3-phase						
9AMH2B-51	9AMH2B-53	118	260	158.6	192	378	120	118	BSP 1.5"	BSP 1.25"	500	200	260	10.8
9AMH3B-51	9AMH3B-53	118	260	158.6	192	378	120	118			500	200	260	12.8
9AMH4B-51	9AMH4B-53	148	304	188.6	222	452	125	125			610	220	260	16.5
-	9AMH5B-53	178	304	218.6	252	482	125	125			610	220	260	17.2
-	9AMH6B-53	208	304	248.6	282	512	125	125			610	220	260	17.8

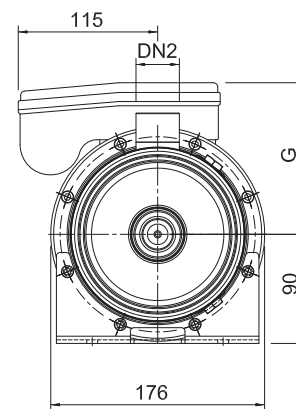
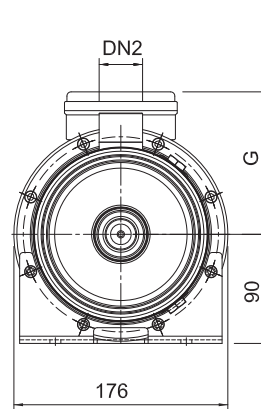
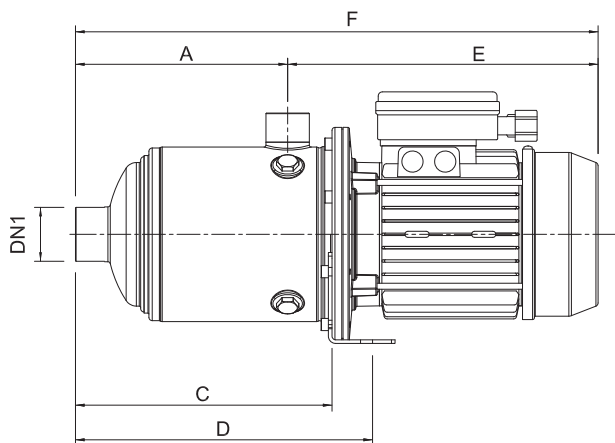

Single-phase
models

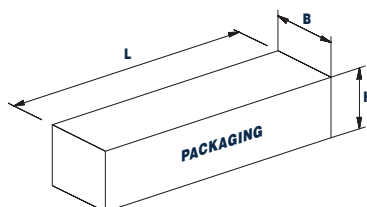
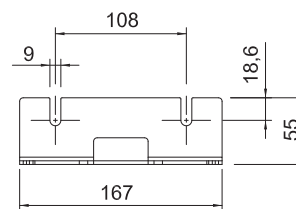

Horizontal Multistage Pumps

50 Hz Stainless Steel

MH 9 Specifications

