



STAGE 1 -

Stage 1 will focus on the rebuilding of the steam workshops, a men's shed and landscaping, as well as headworks and services supply to the site. The vault site will take on a memorial focus, and the site of an interpretive installation telling the fire story. Behind the scenes an Interpretation Plan will also be carried out and the design work associated with Stage 2 will be undertaken.

- 1 SteamWorkshops** are to be rebuilt over existing equipment and slab. Refurbishment of equipment to form 'Men's Shed' restoration project (facilitated through alternate funding) which will also have value with community/ tourist engagement and education. A Men's Shed will be built adjacent to the workshops in which locals can work on the steam workshops, other restoration projects, or their own projects. The men's shed will house a kitchenette and WC, and will be connected to the workshops via a tool store. Connections between the buildings will be glazed, so that visitors can watch the work taking place.
- 3 Vault and Vault court/garden** the vault will remain as it stands today as the only structure to survive the fire. As a striking record of the damage done by the fire, coupled with its proximity to the war memorial on Railway Parade, make the vault a logical place to create a Place of Reflection on the site.
A platform deck and steps are proposed to recreate a space to view and take in the site at the original ground floor level of the mill store office. A framework roof will articulate the former outline of the Mill Store's truss roof structure, an extension of which will provide cover to preserve the vault brickwork.
The mill store site will be the location for the fire story interpretation, which could involve the display of found objects in a series of pigeonholes which represent the original timber storage units in the mill store.
- 4 Turf and Soft Landscaping** Turf and picnic benches would be provided to the southern end of the site around the Men's shed for visitors to the Steam Workshops, and locals.
- 4a Dryland Grasses** The middle to site will not be highly vegetated with trees, as this section will be constructed upon in Stage 2 and 3. As such, it is proposed that dryland grasses be planted in this area as a low maintenance ground cover.



- 2 Tree planting** Significant Eucalypt planting will occur throughout the site. The northern end of the site will be heavily planted as a reference to Yarloop's timber milling history, but will also provide a shaded, serene space for the community and visitors to enjoy in future stages of the project.

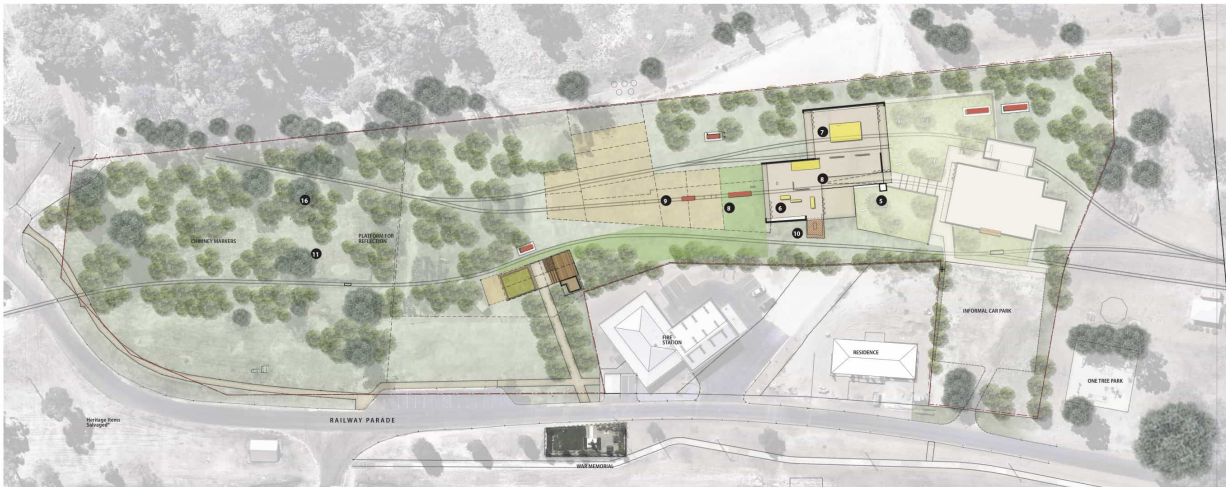

STAGE 2 -

Stage 2 will focus on the reconstruction of the southern portion of the workshops building. This building will house the model railway, salvaged artefacts, restored equipment, and a variety of interpretation exhibits, the nature of which will be determined by the interpretation plan which will be carried out in stage 1. This interpretation will be implemented in Stage 2. Also carried out in this stage will be installation of restored equipment (by others), landscaping and railway line interpretation. The remainder of the workshops building will be articulated as a 3D framework installation which could provide a framework for shade structures or a grassed community events space.

- 5 Heart Beacon** signpost/lighting element to identify the entry to site and act as a signpost from Railway Parade
- 6 Interpretation Centre - Timber History and future** this section of the former workshop site will tell the story of the significance of Yarloop in the serving the timber industry in the south west through historic imagery and display of salvaged and restored historic machinery. The future of the timber industry will be presented in this area looking at the development of timber as a material, and current timber milling and construction technologies. It is envisaged that the interior fitout of the space could be used to demonstrate new products available in the timber industry. This display could be sponsored by FIFWA (Forestry Industries Federation WA) who have expressed interest in donating timber material for the rebuilding of the workshop.
- 7 Interpretation Centre - Model Railway** The Yarloop model railway will be located (if available) in the main workshops building and will be used to interface with an augmented reality display. This part of the facility would be weather protected, and lockable.
- 8 Interpretation Centre - Steam Rail History** is an important part of the story telling of this site and there are many stories to be told, many images to share, and machinery to be displayed. The interpretation Plan will determine the way these elements will best be communicated, but we envisage that, in addition to the restored (and unrestored) equipment from the site, Augmented Reality exhibits could be a very powerful tool to communicate what went on in the workshops. This would involve constructing a virtual representation of the buildings that were on the site using historic photography and 3D modelling, to 'recreate' the site. Visitors could engage with the exhibit using the phone, and/or 3d glasses and feel like they are moving between, and into the buildings. We see a contemporary and technologically based tool such as this being very powerful in communicating the site as it was, and also see it as exhibit that would draw visitors to the site to ensure ongoing financial viability.
- 9 Railway lines** the path of the former railway lines will be imprinted onto the ground plane as an interpretive device. This could be done through patterning in paving, or the integration of timber or steel elements into the paving. Seating elements would also be incorporated to create spaces for people to occupy on the tracks themselves.
- 10 Pattern / Moulding Shop 'Making Space'** This space is proposed to create an interactive display for kids with the beautiful patterns that were located in this area of the site. We'd like to engage kids that visit the site in the pattern making/casting and moulding - process, using timber patterns and sand or clay beds, and perhaps create a memento that they can take away with them. We see the cog shaped patterns being used to create beautiful laser cut screens in corten steel to provide filtered light and shadow in this space, adding another layer of interpretation.

STAGE 3 -

Stage 3 will involve the construction of the remainder of the workshops building footprint to house a food and beverage outlet such as a family friendly pub or microbrewery. Also to be carried out in Stage 3 is completion of the landscaping, with turf for alfresco dining as well as formalised bus and carparking. A series of handcars on tracks could be incorporated to draw visitors around the site.

- 11 Food and Beverage Offer - Restaurant/Micro Brewery** would occupy the northern half of the workshops building footprint. This space would draw on the history of the workshops and the timber industry in its construction and interior design, as a demonstration of the past, present and future of the timber industry. Extensive alfresco dining areas could spill out through surrounding landscaped areas, providing a fantastic family atmosphere. Restored equipment could be incorporated into the space to further enhance the story telling of the site.
- 12 'The Yard' Event Space** protected courtyard space with festoon lighting canopy could be used for functions, community events such as markets, long table lunches, and concerts, catered for by the food and beverage outlet.
- 13 Chimneys** a series of metal clad chimneys symbolic of the brick residential chimneys that survived the fire will line the railway line path in the northern end of the site. The chimneys would have an interpretive element such as historic photographs of the site to encourage visitors to engage with this end of the site.
- 14 A Handcar** could be incorporated as part of Stage 3 to provide an activity for families, and draw visitors up to the northern part of the site. The rail track interpretation implemented in stage 1 could be enhanced to provide a track for a series of handcars that could assist visitors to travel the several hundred metres from one end of the site to the other. Two 'stations' one located at the south of the site the steam workshops, and another at the vault could provide hop on and off locations.
- 15 Carparking** for 50 cars will be located at the southern end of the site at the main entrance. Bus parking will be located adjacent to the fire station.



The Brewhouse Margaret River



SCALE BAR



Griffiths Architects



nbd
marketing



LANDSCAPE ARCHITECTS

gresleyabas
architecture environment design

Stage 3 - Perspective from the East

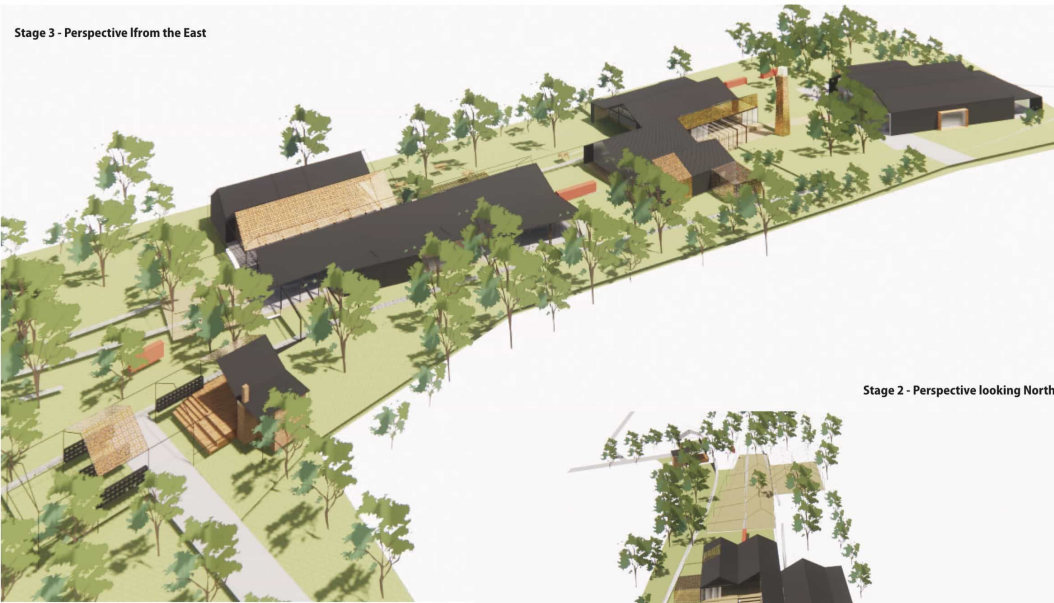

Stage 2 - Perspective looking North



Stage 2 - View from Timber History Interp Centre



Stage 3 - View from Timber History Interp Centre



Stage 3 - Perspective from the South East

YARLOOP WORKSHOP CONCEPT PLAN

The Yarloop Workshops was included in the State Register, in recognition of its importance as the largest privately owned railway workshop remaining in Australia, constructed by Millars in the late nineteenth and early twentieth centuries. It played a major role in the timber industry of Western Australia, which was one of the most important export industries for almost a century.

Prior to its destruction by fire, the place was a complete complex of workshops arranged around a ladder of tracks with a full suite of historic building and contents comprising significant machinery, some of which remained operable, as well as a unique collection of patterns, and collections of associated tools, equipment, fittings and documents.

Following the fire, only the strongroom, steam shop equipment and a collection of equipment and tools provenanced to the site remain.

Our objective for this project is to create a robust conceptual framework for a financially sustainable venture that interprets the rich history of the site and makes strong connections into the town, both physically and intangibly.

We aim to create a vibrant activated space which promotes high visitation from tourists, passers by and a broader audience than just industrial heritage enthusiasts.

We have tentatively called it "The Yard" and envisage it to tell multiple stories about industrial history, timber milling history and the story of fire.

The re-planning of the site has its foundations in its heritage. The planning is organized around the track ladders and the structures that stood on the site prior to the fire. There is very good evidence in a variety of forms to allow the entire memory of the workshops to be re-created with a combination of track related paths, building outlines and some building reconstruction to create a palimpsest of the original concept.

The extent of building outline and building re-construction will be driven by a combination of factors, including endeavouring to locate surviving items in their original location, protection for significant items, and possible programs that might be entertained for the site, providing shade and shelter for visitors.

Key elements such as the running shed will be reconstructed to the extent that is possible, and the steam workshop will be reconstructed to allow the collection of steam equipment to be conserved.

Where reconstruction is not proposed, building outlines will be erected and interpretation will assist visitors to develop an understanding in the whole of the workshop site and the significance of the timber industry in Western Australia's economic history and development. It is likely that programs extending education about the timber industry of the present and future will be part of the interpretive elements of the site.

In essence, the physical environment will allow the whole of the workshops complex to be read in either reconstructed built form, or by means of building outlines and interpretation.

Landscape will play a very important role in this project as a means of interpretation, and as a placemaking tool. We propose both formal spaces such as the memorial garden and court, and more naturalistic plantings such as the forestry plantation and parkland area to the north of the site. This variety of type of space will enable us to create zones with very different spatial qualities within the site, whilst providing an economical and sustainable outcome.

INTERPRETATION

Interpretation of the history of the site is critical for the success of the project. We envisage that numerous tools will be used to communicate the site's history to visitors, including display of found artefacts and restored machinery and oral histories. The interpretation plan that will be carried out in Stage 1 will determine what these tools should be.



Restored Loco, boilers, Loco wheel turning machine and lathes displayed throughout the site

Interpretation Through Augmented Reality An augmented reality exhibit is proposed to connect the visitor with evocative visual and spatial experiences of the former workshops. The exhibit would involve the creation of a 3D model of the whole site, or just the main workshop, which would be stitched together with historic photos of the site. The visitor can access the model by scanning QR codes through their phone and 'walk through' the former workshops as they progress through the site to create a rich and moving experience.



Augmented reality being used to bring an archaeological site to life

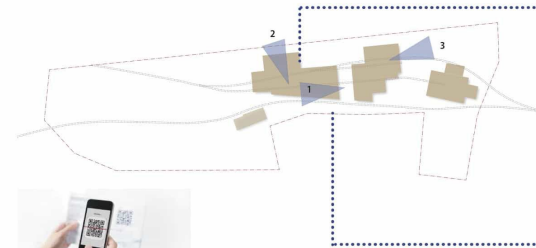

Mobile phone scanning a QR code



Views of the former workshops which can be experienced through virtual reality

CONCEPT PERSPECTIVES



Stage 2 - Entry



Stage 1 - Vault and Mill Store 'Place of Reflection'



Stage 2 - Workshops framework looking south